



THE CORPORATION OF THE TOWN OF OAKVILLE

BY-LAW NUMBER 2017-001

A by-law to amend the Town of Oakville Zoning By-law 2014-014, as amended, to rezone a portion of the Trinity Church Lands at 1250 McCraney Street East, to permit the development of three detached dwelling lots. (Trinity United Church, File No.: Z.1513.27).

COUNCIL ENACTS AS FOLLOWS:

1. Map 19(15) of By-law 2014-014, as amended, is further amended by rezoning the lands identified on Schedule 'A' to this By-law as follows:
 - a) From CU – Community Use to RL5¹¹⁵ - Residential Low SP115
2. Part 15, Special Provisions, of By-law 2014-014, as amended, is further amended by replacing the header of Section 15.115 as follows:

"115 (Old 287)	Romain Cres., McCraney St. E, Sewell Drive, Ryerson Rd., Queens Ave., Parkhill Rd., and Petit Court (Part of Lots 13 and 14, Concession 2 S.D.S.)	Parent Zone: RL5
Map 19(15)		(1980-149) (1989-266) (2017-001)

3. Part 15, Special Provisions, of By-law 2014-014, as amended, is further amended by adding Section 15.115.3 below to Special Provision 115 and renumbering the existing section 15.115.3 Special Site Figures to 15.115.4 Special Site Figures;

15.115.3 Zone Provisions for Block 2 Lands	
The following regulations apply to lands identified as Block 2 on Figure 15.115.1:	
a)	<i>Maximum Lot Coverage:</i> <ol style="list-style-type: none">i. Lot 1 – 27%ii. Lot 2 – 24%iii. Lot 3 – 23%
b)	<i>Maximum Residential Floor Area Ratio:</i> <ol style="list-style-type: none">i. Lot 1 – 34%ii. Lot 2 – 27%iii. Lot 3 – 29%

4. Part 15, Special Provisions, of By-law 2014-014, as amended, is further amended by deleting Figure 15.115.1 and replacing it as follows:

Special Provision 115

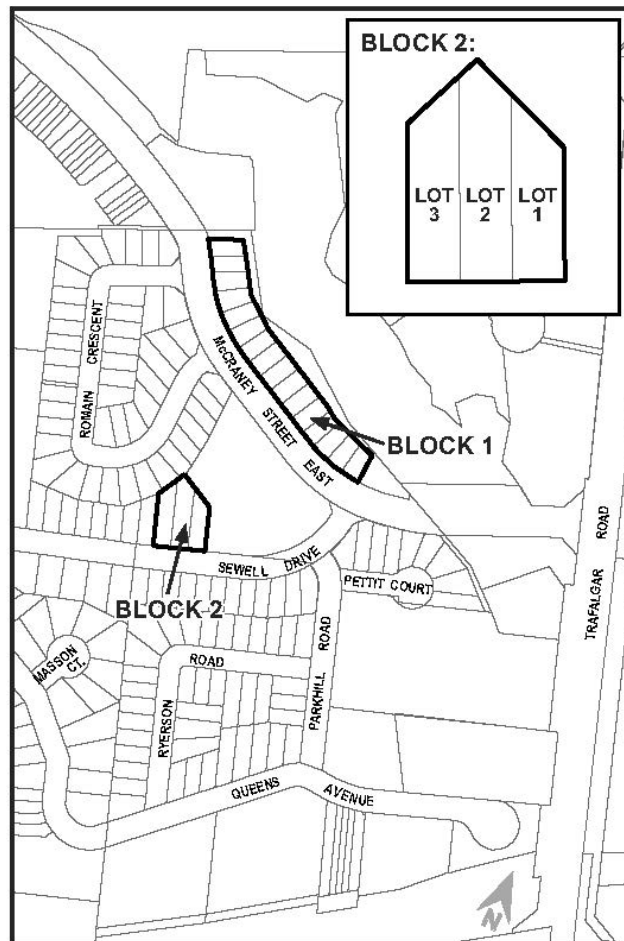

5. This By-law comes into force in accordance with Section 34 of the *Planning Act*, R.S.O. 1990, c. P.13, as amended.

PASSED this 16th day January, 2017.

MAYOR

CLERK

SCHEDULE "A"
To By-law 2017 - 001

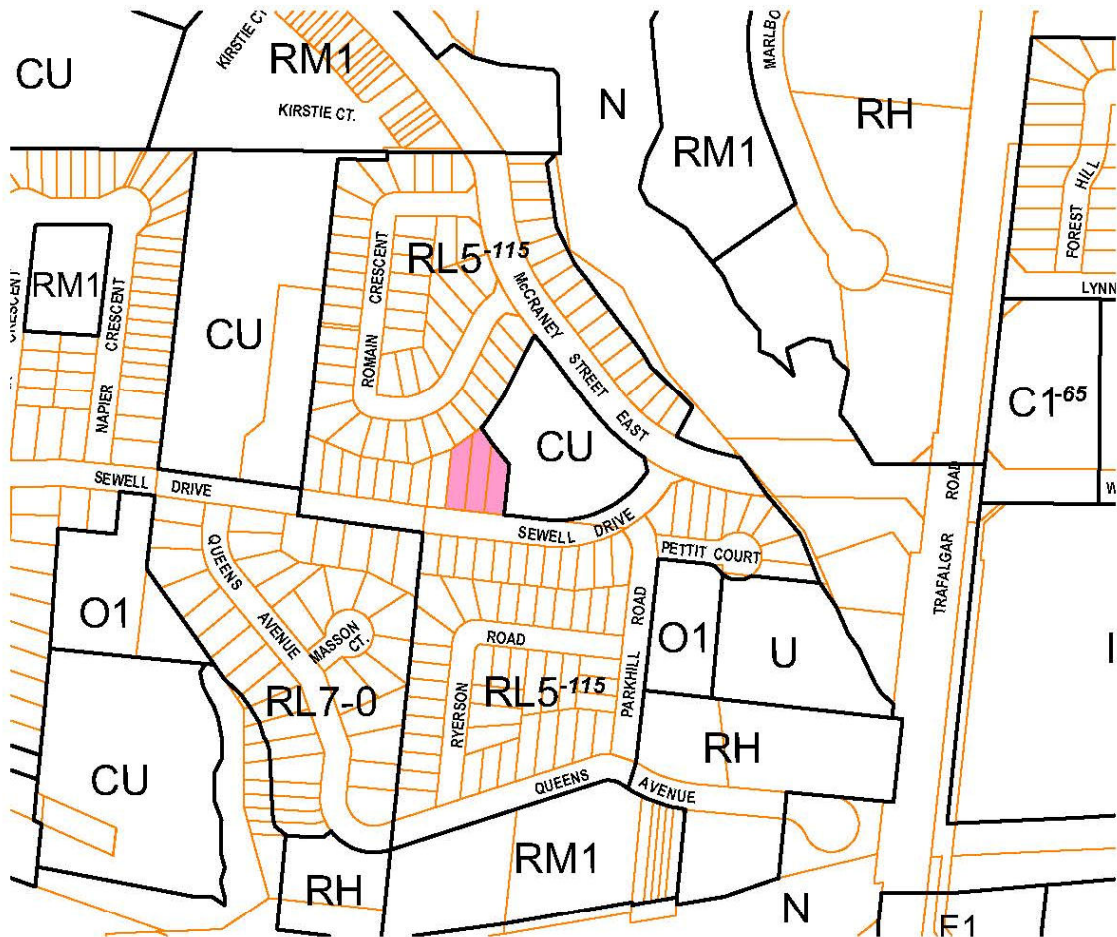

PROPOSED AMENDMENT

 Rezoned from Community Use (CU)
to
Residential Low (RL5 sp:115)

EXCERPT FROM MAP
19 (15)



SCALE 1 : 4250