

P:\792-034 Lions Valley\4. Drawings\2026 03 March\Parking Plan Mar 3 26.dwg

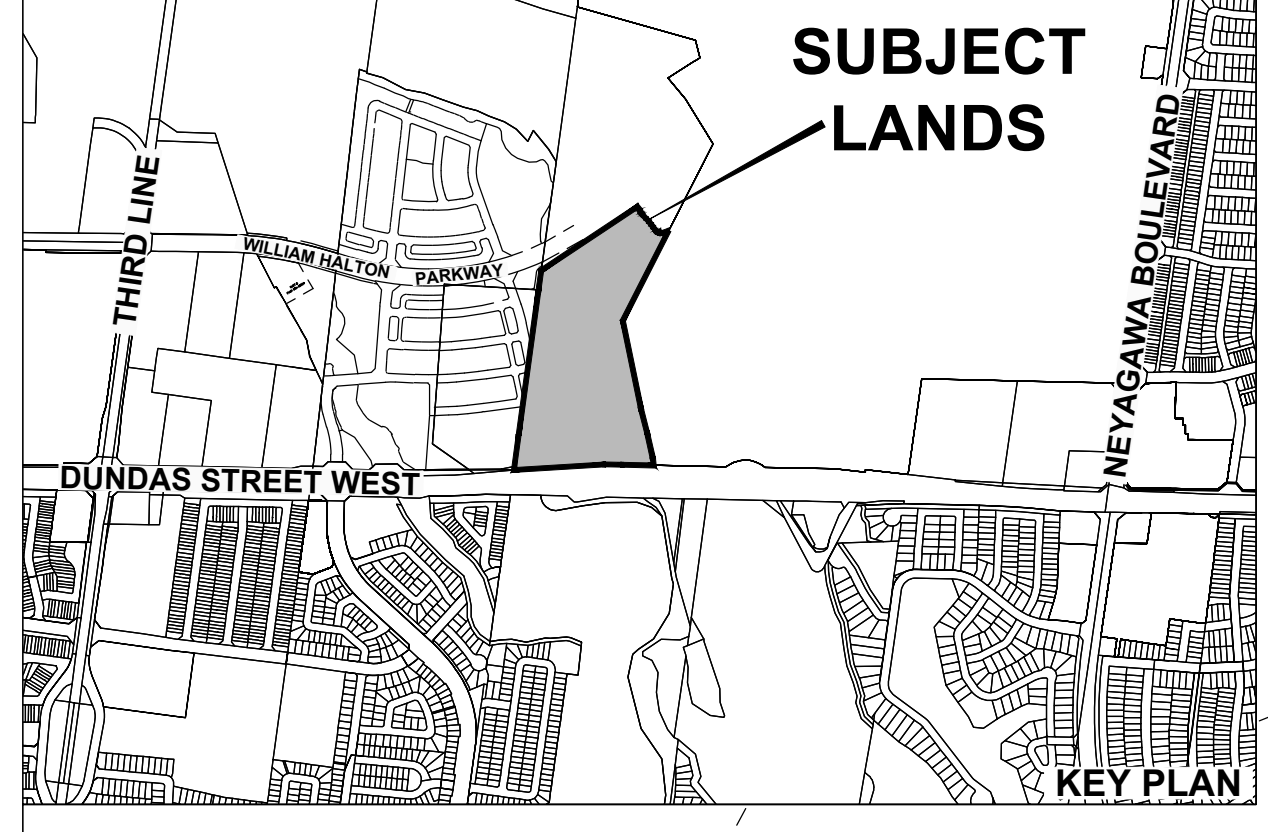
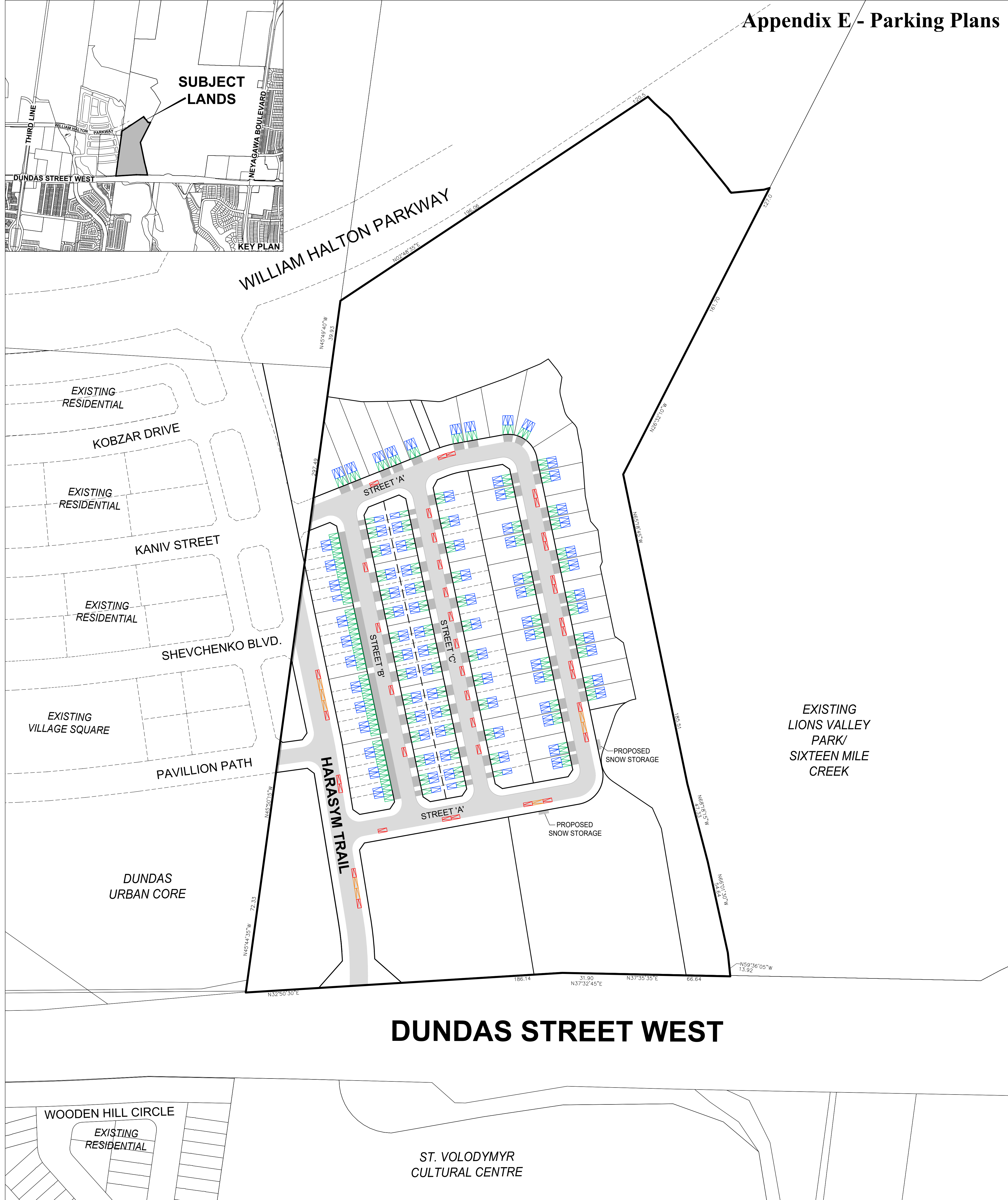

EXISTING LIONS VALLEY PARK/ SIXTEEN MILE CREEK

**DUNDAS STREET WEST**

**PARKING PLAN**  
**ARGO LIONS VALLEY LIMITED**  
 FILE # 24T-25002/1323  
 PART OF LOT 23, CONCESSION 1,  
 NORTH OF DUNDAS STREET  
 (GEOGRAPHIC TOWNSHIP OF TRAFALGAR)  
 TOWN OF OAKVILLE  
 REGIONAL MUNICIPALITY OF HALTON

**Parking Count**

48 - ON-STREET PARKING SPACES

139 - RESIDENTIAL UNITS

0.35 - VISITOR SPACE/UNIT\*

373 - RESIDENTIAL PARKING SPACES

- Legend**
- INTERIOR ON-STREET PARKING SPACE
  - SINGLE AND/OR END ON-STREET PARKING SPACE
  - RESIDENTIAL DRIVEWAY PARKING SPACE
  - RESIDENTIAL GARAGE PARKING SPACE
  - PROPOSED DRIVEWAY (FINAL LOCATION TO BE DETERMINED)
  - PROPOSED SNOW STORAGE

\*ON-STREET / RESIDENTIAL UNITS (48 / 139)

SCALE: 1:1000  
 (24 x 36)  
 MARCH 3, 2026  
 Glen Schnarr & Associates Inc.

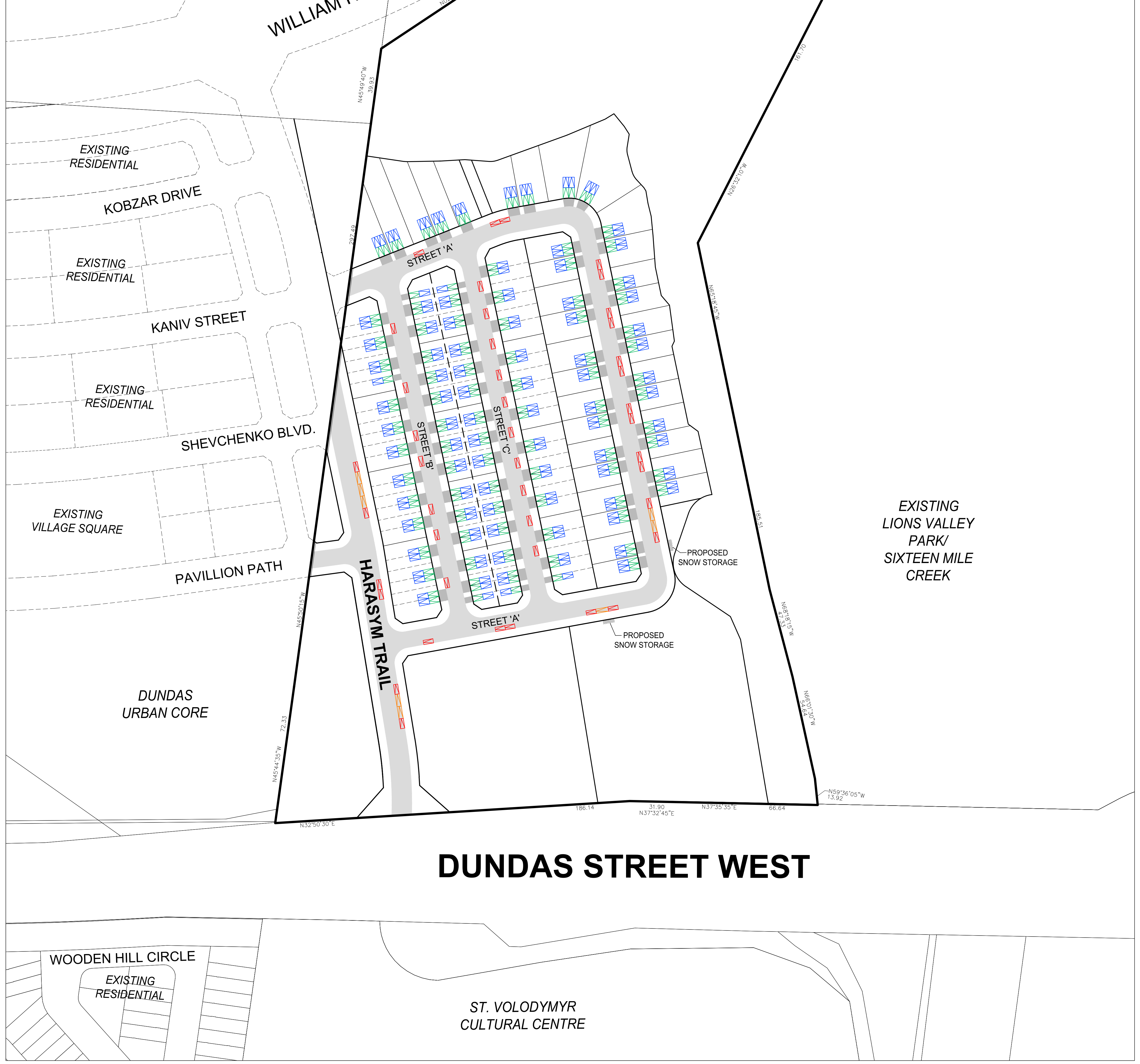
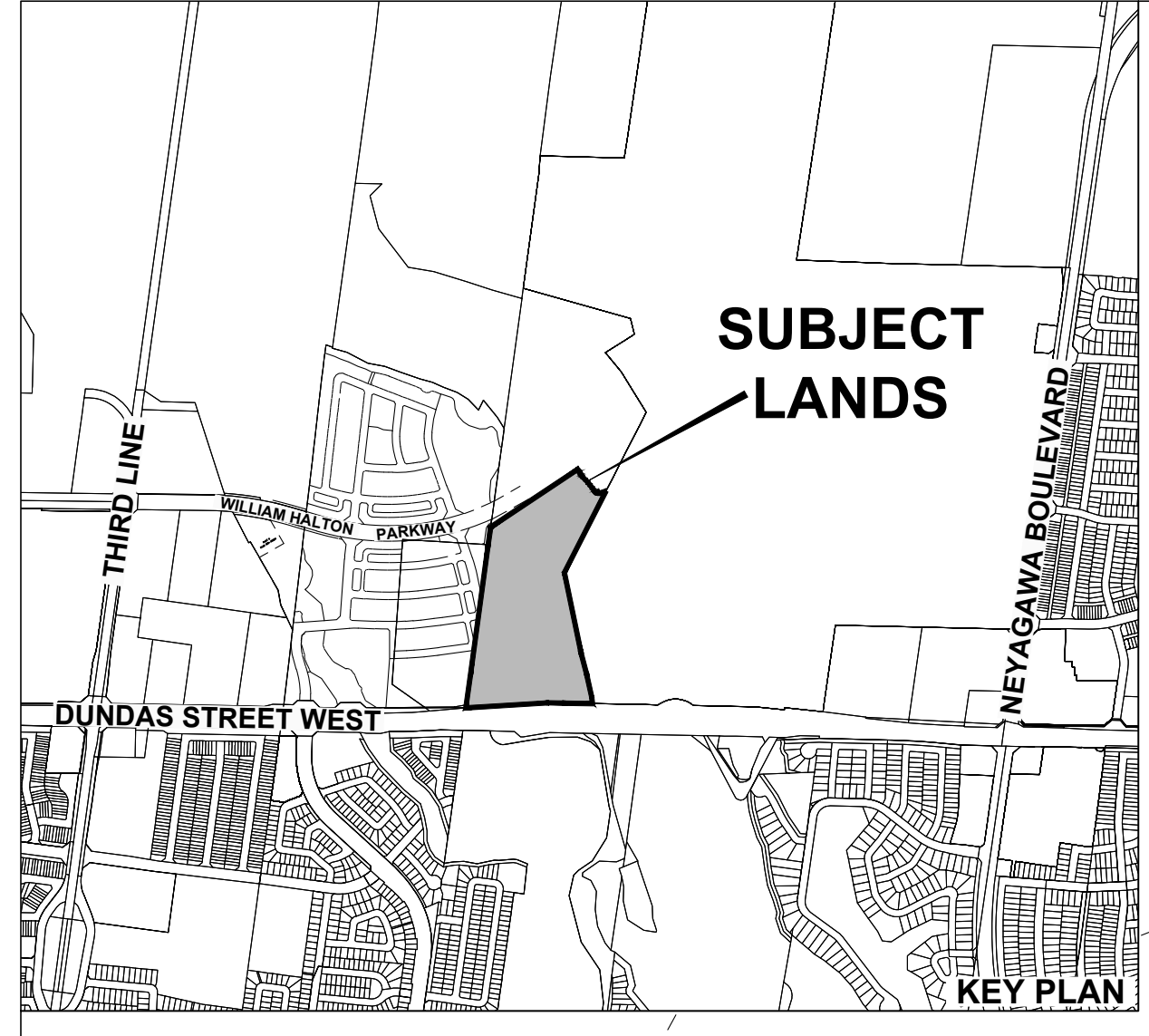

# DUNDAS STREET WEST

**ALTERNATE PARKING PLAN**  
**ARGO LIONS VALLEY LIMITED**  
 FILE # 24T-25002/1323  
 PART OF LOT 23, CONCESSION 1,  
 NORTH OF DUNDAS STREET  
 (GEOGRAPHIC TOWNSHIP OF TRAFALGAR)  
 TOWN OF OAKVILLE  
 REGIONAL MUNICIPALITY OF HALTON

**Parking Count**

51 - ON-STREET PARKING SPACES

139 - RESIDENTIAL UNITS

0.367 - VISITOR SPACE/UNIT\*

348 - RESIDENTIAL PARKING SPACES

\*ON-STREET / RESIDENTIAL UNITS (51 / 139)

- Legend**
- INTERIOR ON-STREET PARKING SPACE
  - SINGLE AND/OR END ON-STREET PARKING SPACE
  - RESIDENTIAL DRIVEWAY PARKING SPACE
  - RESIDENTIAL GARAGE PARKING SPACE
  - PROPOSED DRIVEWAY (FINAL LOCATION TO BE DETERMINED)
  - PROPOSED SNOW STORAGE

	ORIGINAL (2 CAR DRIVEWAY)	ALTERNATE (1 CAR DRIVEWAY)	DELTA
ON STREET PARKING	48	51	3
RESIDENTIAL PARKING	373	348	-25
<b>TOTAL PARKING</b>	<b>421</b>	<b>399</b>	<b>-22</b>

SCALE: 1:1000  
 (24 x 36)  
 MARCH 24, 2026  
 Glen Schnarr & Associates Inc.