

CONSENT SKETCH

2690 Plymouth Dr & 2164 Buckingham Rd,
Oakville, Ontario

LEGEND

- Retained Lands (Parts 1, 2, 3, and 4)
- Severed Lands (Parts 5, 6, and 7)

| SCHEDULE | | | | |
|--------------|-----------------|---------|------------------------------|------------------------|
| PART | BLOCK | PLAN | PIN | AREA (m ²) |
| 1 | Part of Block 2 | 20M-515 | All of PIN 24902-0019(LT) | 8,522.7 |
| 2 | | | | 1.7 |
| 3 | | | | 138.3 |
| 4 | | | | 27.0 |
| Total: | | | | 8,689.7 |
| 5 | Part of Block 2 | 20M-491 | All of PIN 24902-0572(LT) | 13,504.8 |
| 6 | | | | 143.7 |
| 7 | | | | 23.4 |
| Total: | | | | 13,671.9 |
| Grand Total: | | | | 22,361.6 |

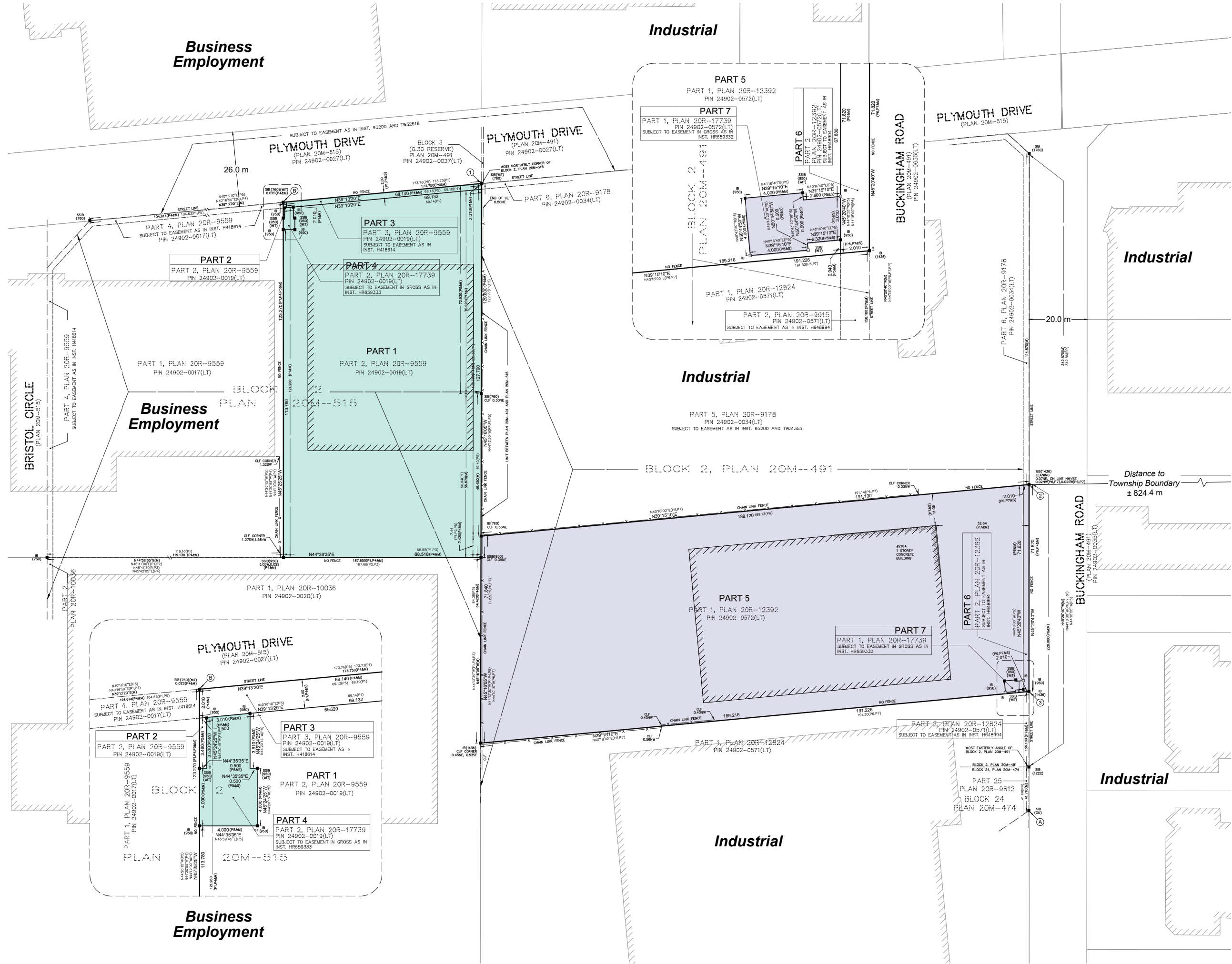

Date: January 15, 2025

Scale: 1:1,250