

Oakville Draft OPA for Midtown

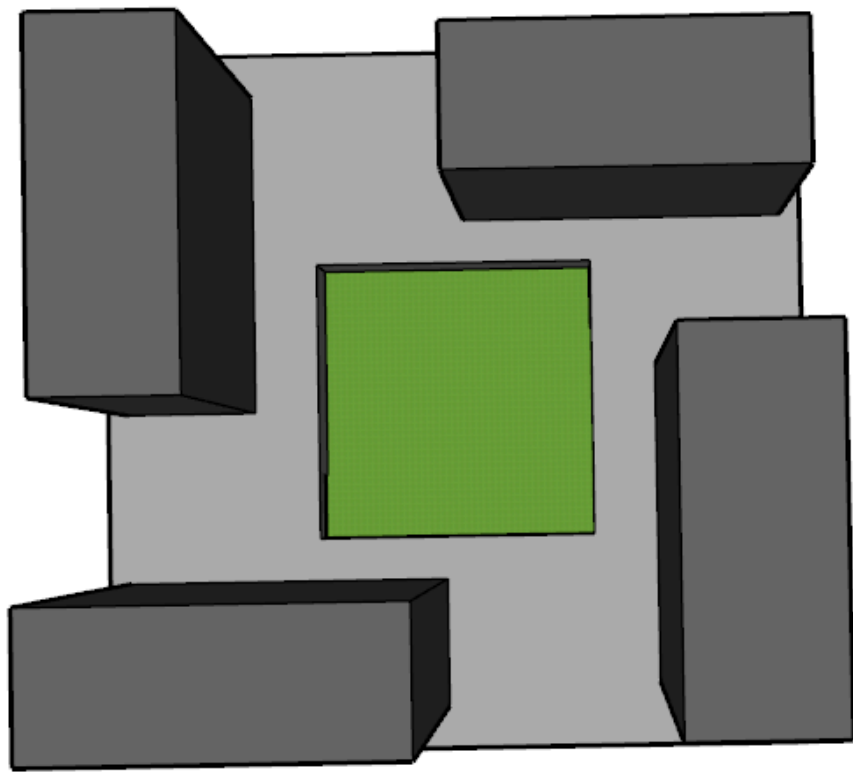

Overhead - Plan View

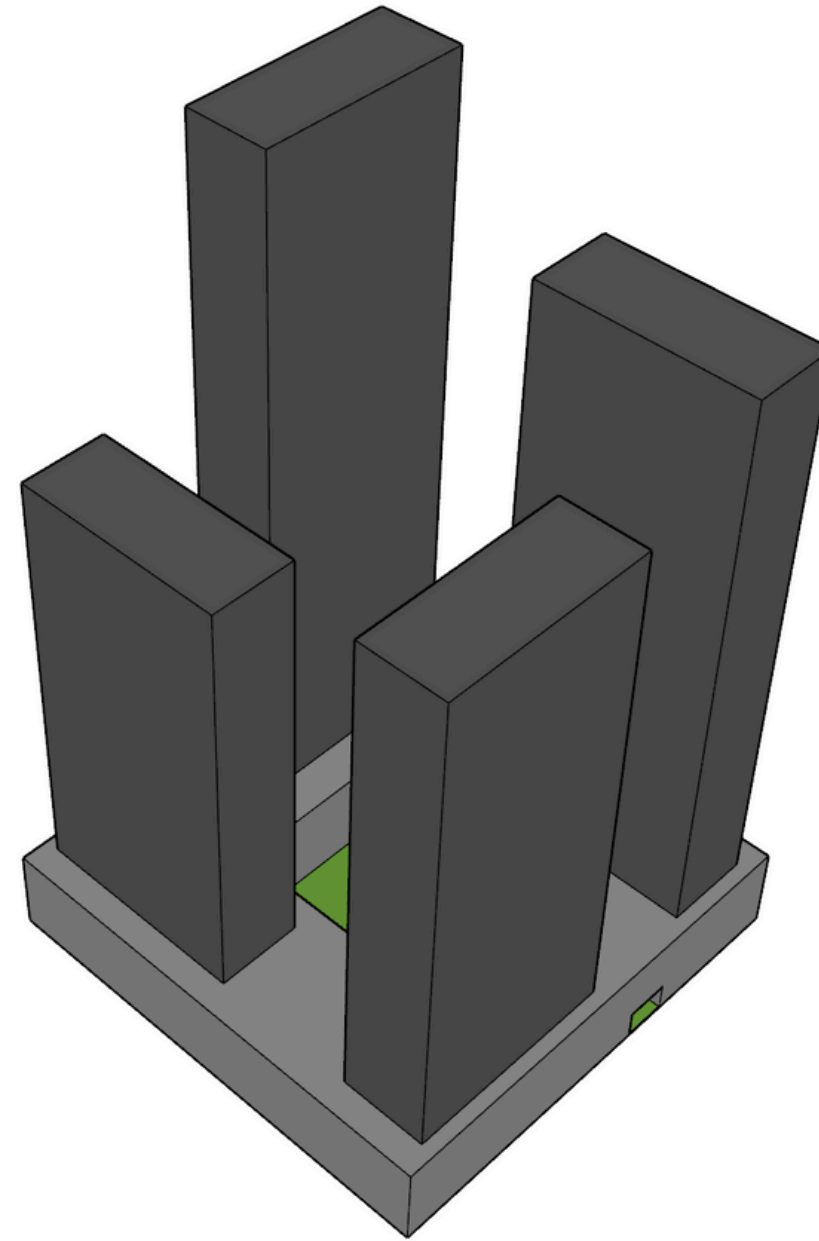

Perspective View

1 Hectare

Built Area = 2.1 million sq. ft.

156 stories in four towers

20 FSI

At 800 sq. ft. per unit =

2500 units =

4500 people + jobs (1.7 PPU) or

5600 people + jobs (2.0 PPU)

Developable Land	1.7 PPU	2.0 PPU	Total Built Area (sq ft)
30 ha	135,000	150,000	63,000,000
40 ha	180,000	200,000	82,000,000
50 ha	225,000	250,000	105,000,000





