

NOTE:
ELEVATIONS SHALL MATCH NEIGHBOURING PROPERTIES AT THE PROPERTY LINE

NOTE:
DOWNSPOUTS SHALL EXIT AT GRADE VIA A CONCRETE SPLASH PAD

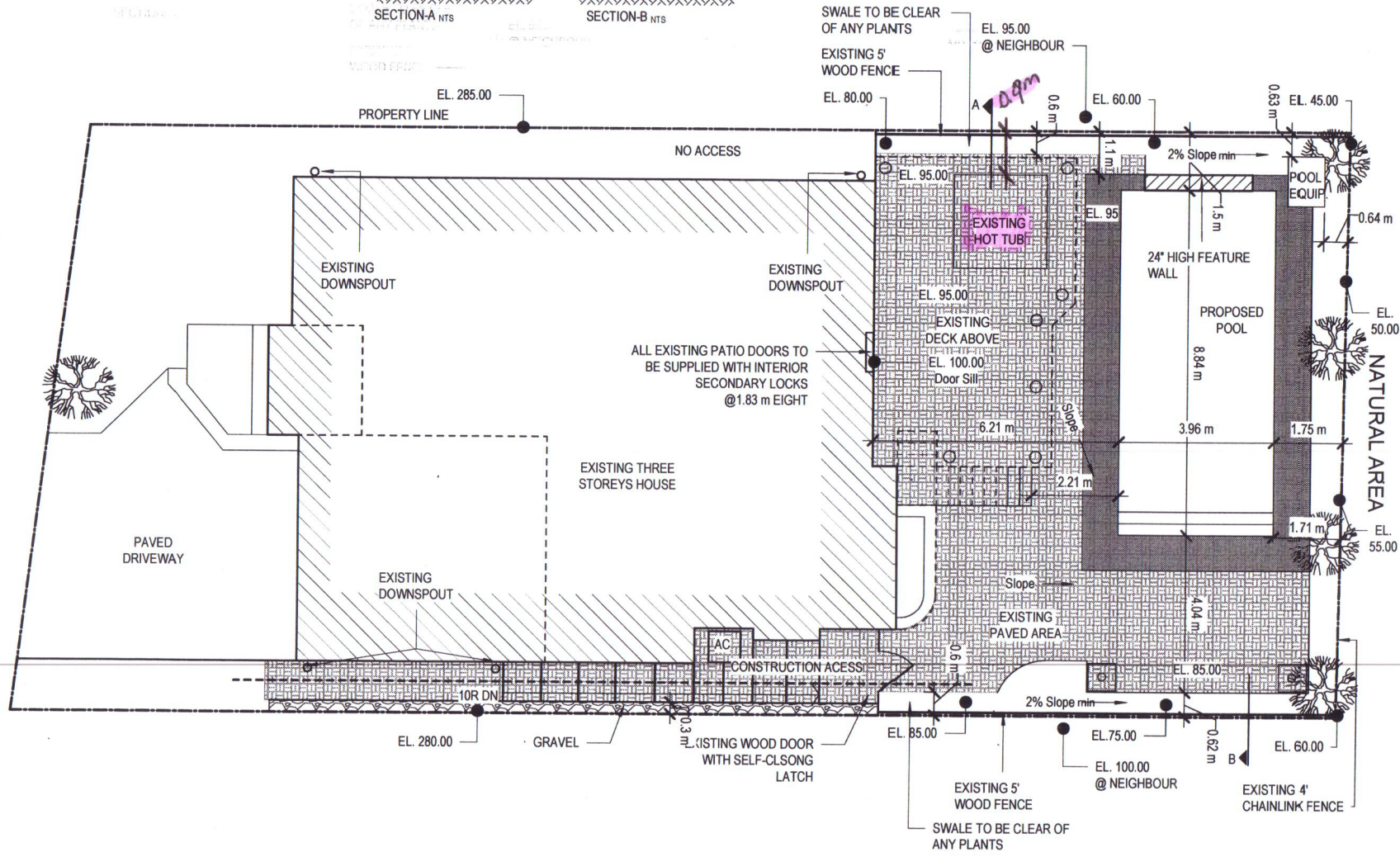
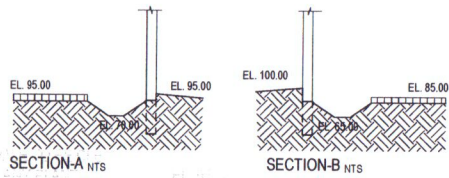

client logo placed here

Project
2258 HILLMOUNT DR

Prepared for
MR. KHALID GAZALA

All reproduction & intellectual property rights reserved © 2019
Key Plan

No.	Description	Date
1	COORDINATION	18-3-21
2	ISSUED FOR PERMIT	26-3-21
2	RE ISSUED FOR PERMIT	5-4-21

Project No. 21.10052.00
Sheet Title
SITE PLAN

Original is 17 x 11. Do not scale this drawing
Sheet Number

NOT FOR CONSTRUCTION

A101

2021-04-09 12:33:18 AM

Date: April 6th, 2022

Cover explanatory letter

To Committee of Adjustment - Town of Oakville

Re: Minor Variance - Property 2258 Hillmount drive, Oakville, L6M 0H8

Dear Sir / Madam

I am writing to you to explain the reason behind my application,
In 2013 I installed a hot tub in my backyard, back then it was placed in a location only 90 cm away from my neighbor's property line. Unfortunately i was not aware that the regulations require 150cm distance to be cleared!

After that in 2018, I built a high deck over the hot tub, which required by design the installation of posts surrounding the tub. At that time I was not made aware that the tub was not properly located. The Town of Oakville permitted the deck and the work was inspected and passed. (drawings attached)

After that in 2021, I submitted for a permit to build a pool in the backyard and now I am told that the tub needs to be moved further 60cm away from my neighbor's property line. Moving this tub is not possible due to the location of the posts that are in close proximity to its location. My neighbor never minded the location of the tub and he is fine with keeping it where it is right now.

I request from the Committee of Adjustment to accept my application for minor variance for the purpose of keeping the hot tube in its current location.

Yours truly,

Khalid Gazala

between the drawn and written dimensions, the written dimension shall prevail. Due to local differences in building codes and regulations, and specific site conditions, these drawings may need to be modified by the builder to comply with such local codes.



GENERAL D
16" DIA. SONOTUBE FOOTING BEL ON FOUNDATION PLAN
(2) 2 x 10 P.T. BEAM(S), SEE PLAN
(2) 2 x 10 P.T. BAND(S), SEE PLAN
8 x 8 P.T. COLUMN (TYPICAL), TRE
2 x 6 P.T. BRACING (TYPICAL), SEI

[illegible]